

PACKING LIST

1. Shaker Motor
2. Shaker Motor Cable
3. 2x Quick Slide Connectors
4. Overload Protection Diode
5. Shrink Tubing

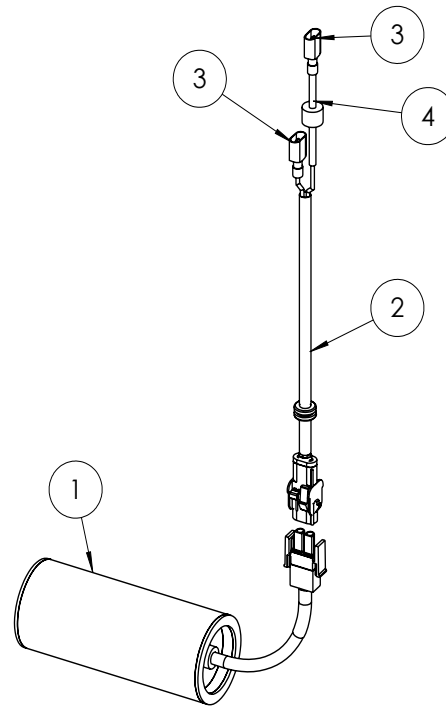

DIAGNOSING A FAULTY SHAKER MOTOR

If your shaker motor has stopped working or is making unusual noises, it may need replacement. For Further assistance and troubleshooting, contact Vaniman Support.

For video instructions, visit: www.Vaniman.com/shaker-motor-replacement/.

INSTALLATION INSTRUCTIONS

Tools Needed:

- Large blade screwdriver or 5/16" nut driver
- Crimping tool or pliers

Replacing a StoneVac Shaker with Quick Slide Connectors:

- 1. Access the Top Panel:**
 - Remove the eight (8) screws from the top panel of the StoneVac unit using a Phillips head screwdriver.
 - Slide the panel towards the front of the unit, then lift it off to remove.
- 2. Locate the Shaker Motor:**
 - Open the unit's front door to reveal the shaker motor.
 - Use a large blade screwdriver (or 5/16" nut driver) to loosen the band clamp securing the shaker motor.
- 3. Disconnect Wiring:**
 - Locate the shaker motor cable in the top compartment of the unit. Remove the quick connectors from the switch.
 - Cut the wires connected to the shaker motor just below the quick slide connectors. **Be careful not to cut the wires connecting the quick slides to the StoneVac unit.**
- 4. Remove the Shaker Motor**
 - Pull the shaker motor cable out through the grommets until it is in the lower portion of the unit.
 - Remove the shaker motor from the unit.

5. Install the New Shaker Motor:

- Place the new shaker motor into the clamp and tighten it securely.
- Thread the new shaker motor cable through the grommet into the top compartment.

6. Attach Quick Slide Connectors:

- Using the provided quick slide connectors, crimp them onto the exposed wires with a crimping tool or pliers. Ensure the bare wire contacts the metal inside the connector while the crimped area grips the wire sheath.
- Connect the quick slide connectors to the switch terminals or the existing quick connectors (depending on unit).

7. Test the Motor:

- Test the motor, keeping your hands clear of the unit. **Do not run the shaker motor for more than five (5) seconds or more than twice per day.**

8. Reassemble the Unit:

- Replace the top panel by setting it on the case and sliding it towards the back.
- Secure the panel with the eight (8) screws and close the front door.

Replacing Shaker with plastic housing/plus style connector:

1. Access the Shaker Motor:

- Open the unit's front door to reveal the shaker motor.
- Loosen the band clamp securing the motor using a large blade screwdriver or a 5/16" nut driver.

2. Disconnect the Motor:

- Unplug the plastic connector housing from its mating cap housing.
- Remove the shaker motor from the unit.

3. Install the New Shaker Motor:

- Place the new shaker motor into the clamp and tighten it securely.
- Connect the new plug housing to the mating cap housing, ensuring the connector seal is correctly positioned between the two housings.

4. Finalize Installation:

- Close and secure the door to the unit.
- Test the motor as described above.

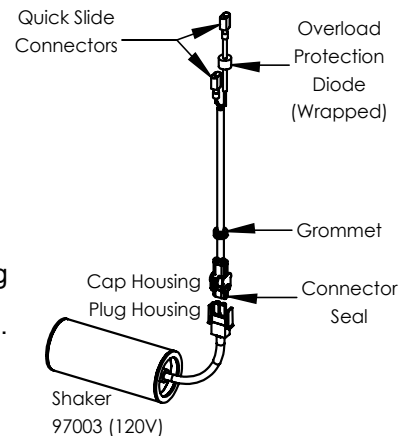

Important Note on Diode Installation:

The replacement kit includes a diode and shrink tubing. **Only use the diode if your current shaker motor already has one installed.**

1. Check the existing shaker motor wire harness for a diode.
2. If your current unit lacks a diode, do not install the replacement diode.
3. If needed, follow the schematic provided for proper diode installation.

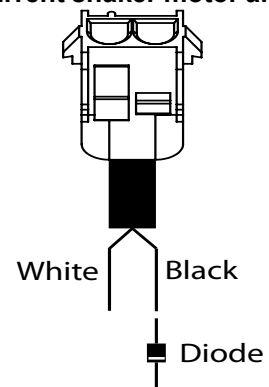

Replacement Shaker Motor Part Numbers:

- **120V:** PN 97003
- **220V:** PN 97004